



TEN-FMN2 - Customer Drop Enclosure Installation Guide

Rev. 1.40/04.2026

Contents

Getting Started.....	1
Introduction	1
Package Contents.....	1
About the TEN-FMN2 Customer Drop Enclosure.....	2
Product Specification - General	2
Mechanical Layout	2
Installation Instructions	3
General Preparations and Precautions	3
Installation Guidelines - Drop Cable Configuration	4
Installation Guidelines - Direct Splice Configuration	9
Legal Declarations	13

Getting Started



TEN-FMN2 - Customer Drop Enclosure

Introduction

The TEN-FMN2 is a unique IP68-rated customer connection enclosure designed to support up to four customer connections, either via adapters or direct splicing, with additional support for pass-through cabling. The enclosure is highly compact and can be directly buried or placed in our specially designed handhole, which support both surface and below-ground installation.

Package Contents

Kindly unpack the TEN-FMN2 and confirm that all items are present, as illustrated in Figure 1. Should any items be missing, please promptly contact your local seller for assistance.



Figure 1 - Package contents

The TEN-FMN2 base configuration includes the enclosure, adapter holders, splice holder, cable ties and foam tape (adapters and pigtails available in various configurations).

Installation Instructions



Warning! Ensure to follow basic safety precautions to reduce risk of fire, electrical shock, and personal injury.

Thank you for choosing this Teleste product. Please take a moment and carefully read these instructions through before installing the product.

General Preparations and Precautions

1. Check the Customer Drop Enclosure, cable items and all other components for any damages before installation.
2. Make sure to keep all components dry and clean for the installation.
3. Keep the working environment clean (dry and no dust) and flat for the installation.
4. Standard instruments and tools should be used during the installation.
5. The TEN-FMN2 base tray supports attaching various components, such as splitter, splice, and adapter bridges. Figure 3 illustrates how to remove the base tray and how to align, press down, and slide a bridge to seat it securely.

1

To remove the base tray, press it downward and slide it out of its locking position.



2

Select the desired component and align it precisely with the tray cut-out



3

Press down and slide to the side until the component (such as a splitter, splice, or adapter bridge) seats firmly.

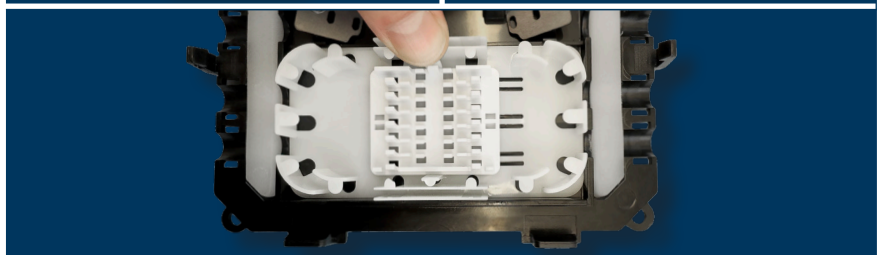

4

Put the tray back in place and press on the side until you hear a click. Ensure the tray is securely locked.

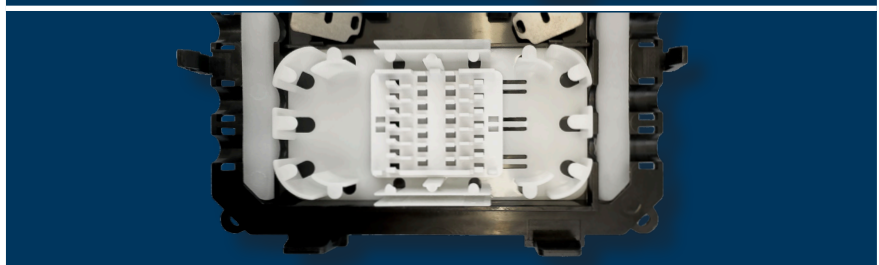

Figure 3 - Attaching a bridge to the base tray



All necessary safety instructions must be followed during the installation and maintenance operations. The safety requirements for class 1M lasers are detailed in EN60825-1.

Installation Guidelines - Drop Cable Configuration

1. Start by loosening the incoming cable clamp screw and the corresponding strain relief screw.



Picture 1



Note! Properly securing the cable is crucial to maintaining the integrity of the optical fibers. Movement and stress on the fibers can lead to physical damage, such as microbends or fractures, disrupting the transmission of light. This can cause poor network performance.

2. Next, insert a cable tie into the cable clamp, lead the incoming cable through it, and tighten the cable tie. Ensure the tie is not over-tightened.



Picture 2

3. Continue inserting the incoming cable. Reinstall the clamp and tighten its screw. Position the cable's strength member in the terminal, then secure it by tightening the screw.

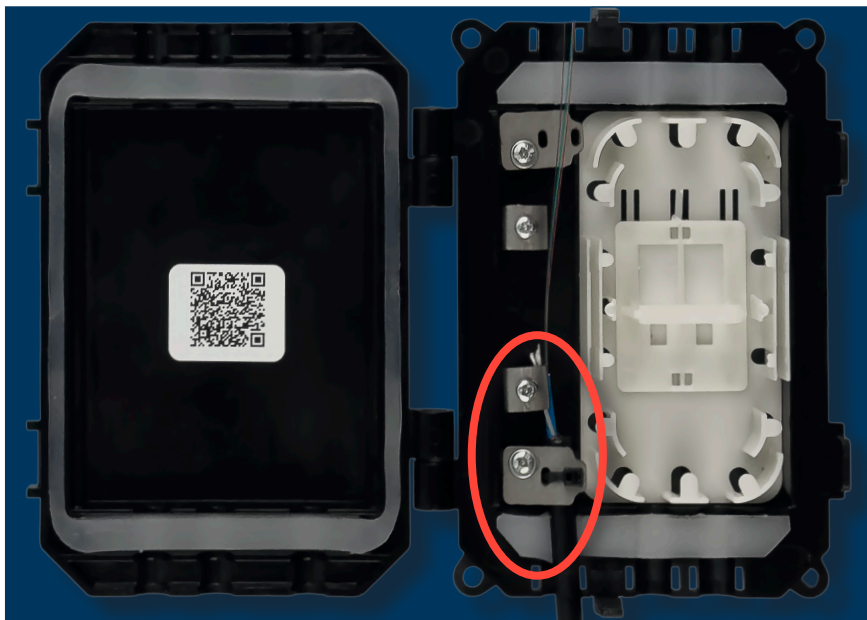

Picture 3

4. Arrange the fibers around the fiber guides, then cut them to length.



Note! Optical fibers should not be damaged. Cut the damaged fiber, and re-strip the fiber if any damage occurs.



Picture 4



Note! Always clean optical adapters and connector end faces as part of the enclosure installation; this is crucial for maintaining optimal network performance. Be sure to follow proper cleaning techniques and inspect connectors and adapters before installation.

- Next, install the optical adapters in the enclosure. Clean the connector end faces of the pigtailed and install them. Then arrange the pigtail fibers and cut them to length.

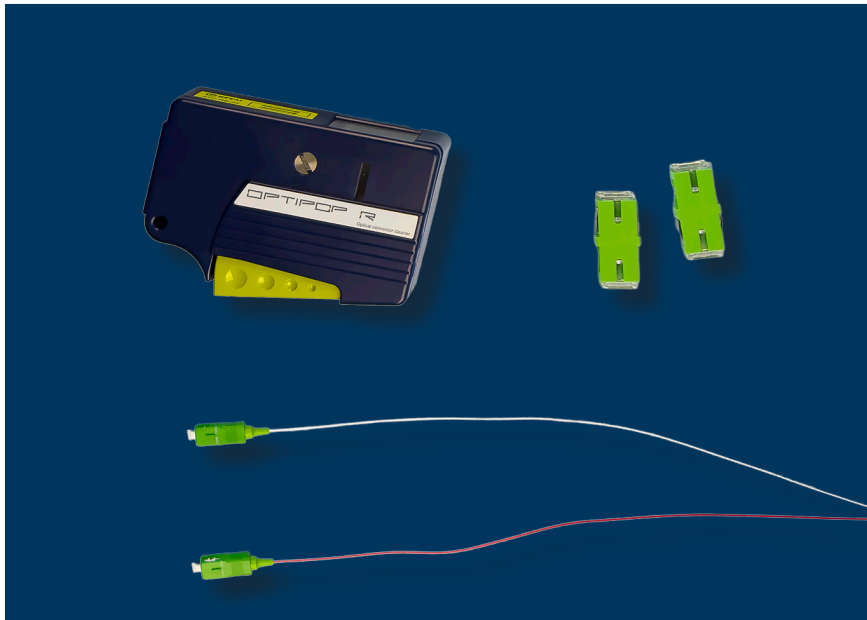

Picture 5

- Begin unwinding the fibers and prepare them for splicing. Then, splice the appropriate fibers for your project.

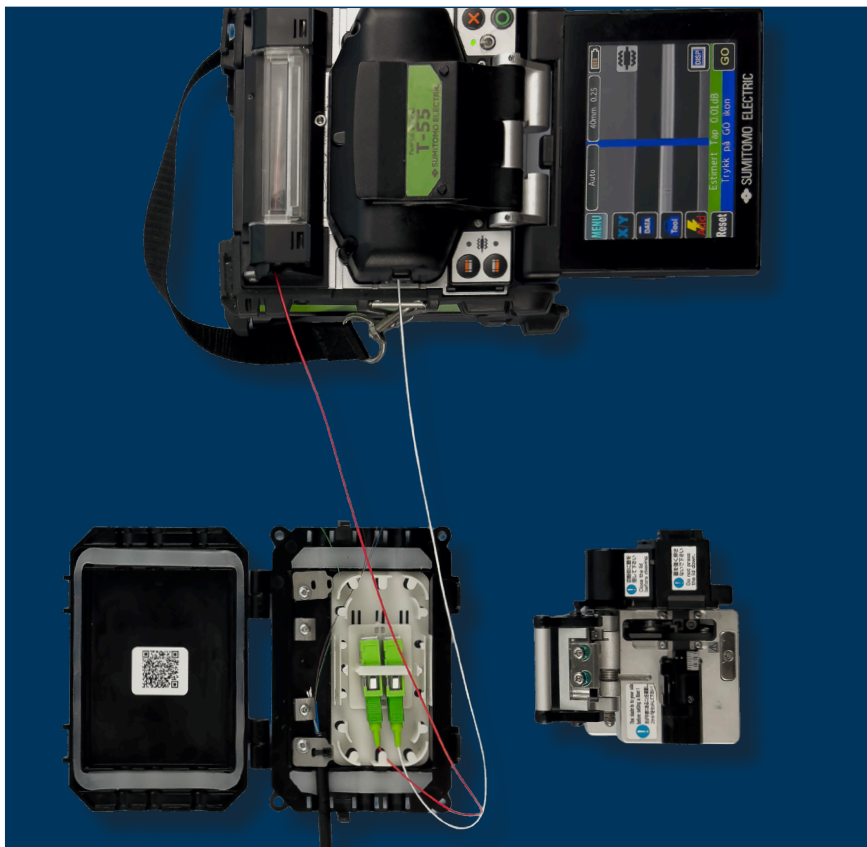

Picture 6

7. Neatly place the spliced fibers back into the tray to avoid any bends or stress that could affect performance, then organise the fibers.



Picture 7

8. Remove the dust caps from the adapters. Prepare to connect the drop cable(s) by cleaning the connector end face(s).

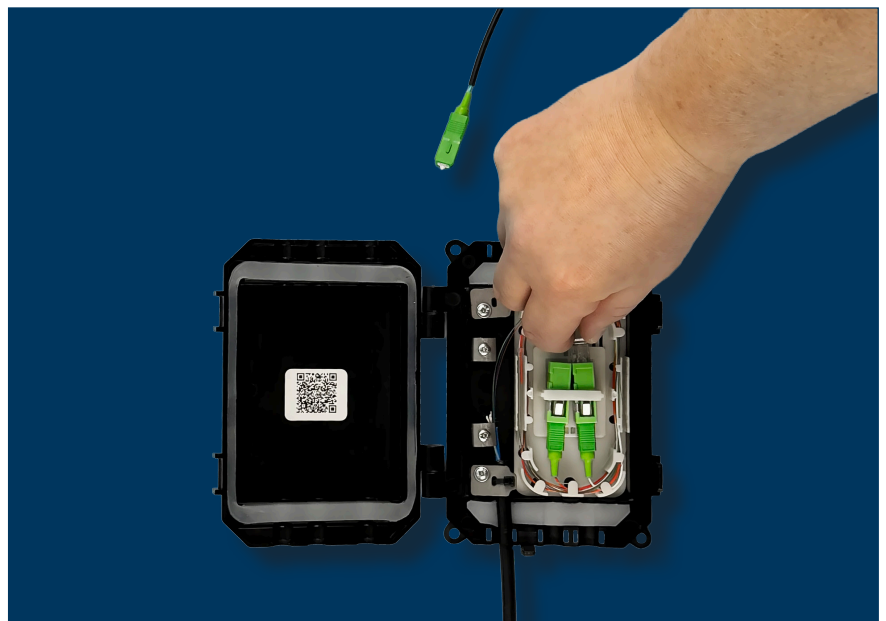

Picture 8

9. Next, proceed to secure the cables. If needed, wrap foam tape evenly around the cable(s), then carefully secure the cable(s) with cable tie(s) inserted into the appropriate tie mounts.



Note! If needed, apply the included foam tape to adjust the diameter of the cable for a more secure hold. This may be necessary when the cable is slightly undersized.



Picture 9

10. Complete the installation by securely closing the enclosure. The TEN-FMN2 features a SMART PressGuard system—an effective safeguard for fiber integrity—for opening and closing. To close the enclosure properly, hold it firmly between your fingers and thumbs, then press with centered pressure until you hear a click.



Picture 10



All necessary safety instructions must be followed during the installation and maintenance operations. The safety requirements for class 1M lasers are detailed in EN60825-1.

Installation Guidelines - Direct Splice Configuration

1. Start by loosening the incoming cable clamp screw and the corresponding strain relief screw.



Picture 11

2. Next, insert a cable tie into the cable clamp, lead the incoming cable through it, and tighten the cable tie. Ensure the tie is not over-tightened. At this point wrap foam tape evenly around the cable to provide a secure and protected hold for when cable ties are later inserted and tightened through the appropriate tie mounts (as shown by the red circles in Picture 14).



Note! If needed, apply the included foam tape to adjust the diameter of the cable for a more secure hold. This may be necessary when the cable is slightly undersized.



Picture 12



Note! Properly securing the cable is crucial to maintaining the integrity of the optical fibers. Movement and stress on the fibers can lead to physical damage, such as microbends or fractures, disrupting the transmission of light. This can cause poor network performance.

3. Reinstall the clamp and tighten its screw. Position the cable's strength member in the terminal, then secure it by tightening the screw.

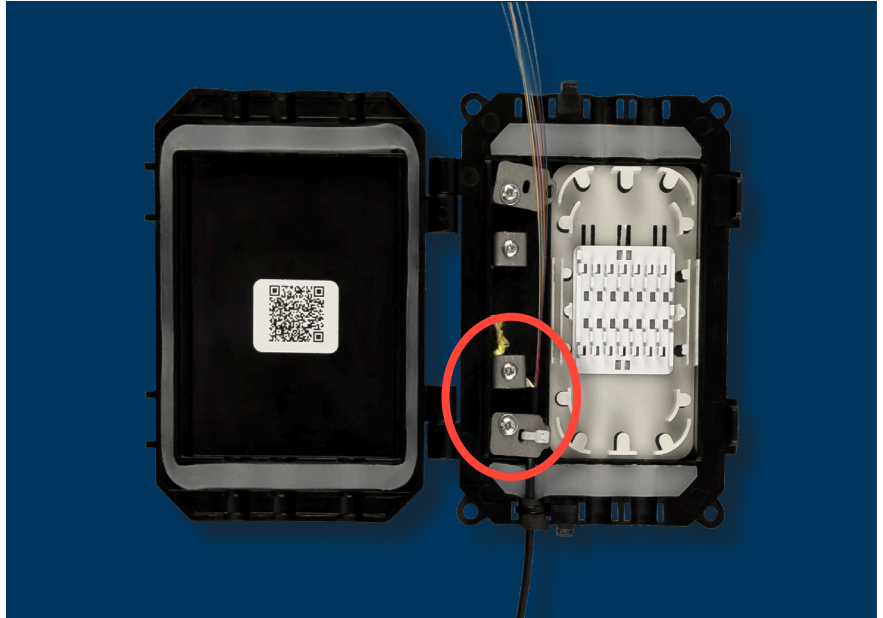

Picture 13

4. Repeat steps 1–3 for the outgoing cable.
5. Next, secure the cables with cable ties inserted into the appropriate tie mounts. Then arrange the fibers and cut them to length.



Note! Optical fibers should not be damaged. Cut the damaged fiber, and re-strip the fiber if any damage occurs.

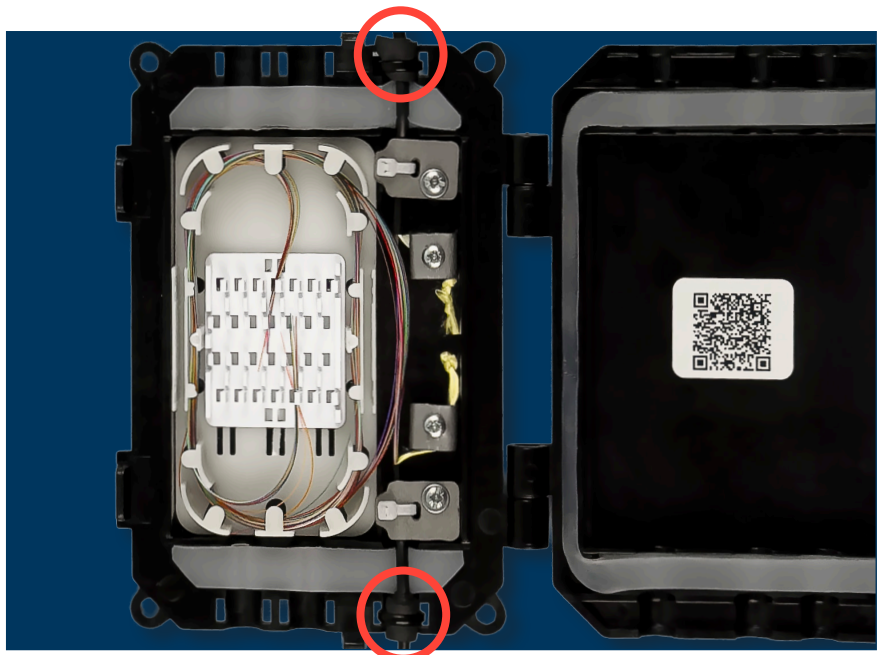

Picture 14

8. Complete the installation by securely closing the enclosure. The TEN-FMN2 features a SMART PressGuard system—an effective safeguard for fiber integrity—for opening and closing. To close the enclosure properly, hold it firmly between your fingers and thumbs, then press with centered pressure until you hear a click.



Picture 17

Legal Declarations

Copyright © 2026 Teleste Corporation. All rights reserved.

TELESTE is a registered trademark of Teleste Corporation. Other product and service marks are property of their respective owners.

This document is protected by copyright laws. Unauthorized distribution or reproduction of this document is strictly prohibited.

Teleste reserves the right to make changes to any of the products described in this document without notice and all specifications are subject to change without notice. Current product specifications are stated in the latest versions of detailed product specifications.

To the maximum extent permitted by applicable law, under no circumstances shall Teleste be responsible for any loss of data or income or any special, incidental, consequential or indirect damages howsoever caused.

The contents of this document are provided “as is”. Except as required by applicable law, no warranties of any kind, either express or implied, including, but not limited to, the implied warranties of merchantability and fitness for a particular purpose, are made in relation to the accuracy, reliability or contents of this document.

Teleste reserves the right to revise this document or withdraw it at any time without notice.



TELESTE

TELESTE CORPORATION

P.O.Box 323

FI-20101 Turku, Finland

www.teleste.com

Copyright © 2026 Teleste Corporation. All rights reserved. Teleste and the Teleste logo are registered trademarks of Teleste Corporation. Other product and service marks are property of their respective owners. Teleste reserves the right to make changes to any features and specifications of the products without prior notice. Although the information in this document has been reproduced in good faith, the contents of this document are provided "as is". Teleste makes no warranties of any kind in relation to the accuracy, reliability or contents of this document, except as required by applicable law.